

### SENSE - At A Glance

SENSE is a NEW exclusive and innovative interactive digital signage solution designed with a programmable Smart Sensor that detects human distance from a display, kiosk, counter or any desired area for digital signage.

### Imagine the Advantage

Are you looking to lure someone to a display, kiosk, end-cap or general area, to increase customer engagement and enhance his or her dwell time? SENSE allows you to play different video (or image) content based on proximity [See It In Action](#). Play an "attract" looping video until someone approaches the desired distance from your display or screen. Program the smart sensor to play new content depending on the distance of the viewer. For example, you may play a video that captures attention to the area. You may then trigger a different video when a person comes within 3 feet of the display. Additionally you may trigger an "exit or goodbye" video when the person walks away from the targeted area. Essentially the effect is that the person is being lured to come closer to the display, encouraged to be further be engaged and then left with a with a lasting impression with an exit video upon departing the area.

### The Details

SENSE has a variety of settings and options that may be customized using a simple dial located on the SENSE control board.

### Examples & Scenarios

- Program sensor to detect movement from 3' to 16' away from display
- Program sensor to play attract video for a desired time
- Program sensor to trigger secondary video when someone becomes even closer to display
- Adjust delay times when guest enters or exists the detection zone. For example if after your guest leaves the display you may wish to implement a three second delay before playing the attract video again
- Exit video may be included by adding a separate video file. If you wish to bypass the exit video option, simply duplicate your attract video and name it as your exit video. (see operations manual for more details)

### Specifications

- SENSE Smart Sensor dimensions: 70mm x 30mm x 35mm
- SENSE control module dimensions (in wire - 5' from SENSE detector)
- Range: 100cm to 550cm / 40 inches to 18 feet
- Compliant with RoHS directive(2002/95/EC)
- Max input for max output: 160mVrms per channel
- Operation voltage : 4.5 to 5.5 V / Consumption current : 30 mA
- Warranty: 2 Years

### In The Box

- 1 SENSE range detector with hardwired 6' harness with built in (in line) control module
- VP71 XD Digital Signage Media Player
- Multi Function Remote Control
- 5VDC External Regulated USB Power Supply
- 8 Gig (Or Higher) Class 10 SD Card Drive
- 8 Gig (Or Higher) Class USB Thumb Drive
- 6 Foot High Quality Shielded HDMI Cable
- 6 Foot Male RCA To Male RCA Audio & Video Cable



**Included** - VP71XD Industrial Media Player (\$348 Value)



**Optional** - Mounting bracket includes hardware

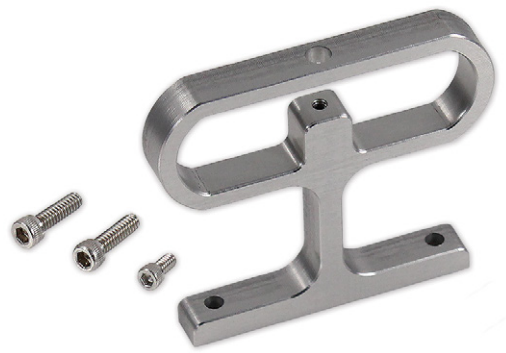

**Optional** - USB RS232 Communication Cable  
(Integration of SENSE with a 3rd party solution)

